



HANSON RIVET

& SUPPLY CO.

13241 Weidner Street
Pacoima, CA 91331

Phone: 818-485-0500

FAX: 818-485-0540

Outside CA: 1-800-RRRIVET

www.hansonrivet.com



900 SERIES SPIN-SPIN THREADED INSERT TOOLS



PART NUMBER	MODEL	SET-UP'S INCLUDED WITH TOOL	UNIFIED THREAD REPLACEMENT NOSE ASSEMBLY	METRIC THREAD REPLACEMENT NOSE ASSEMBLY
RT-901-440	901-440	4-40	RTP-NA-0440	RTP-NA-M3
RT-901-632	901-632	6-32	RTP-NA-0632	
RT-901-832	901-832	8-32	RTP-NA-0832	RTP-NA-M4
RT-902-1032-24	902-1032-24	10-32 & 10-24	RTP-NA-1032-24	RTP-NA-M5
RT-903-2520-28	903-2520-28	1/4-20 & 1/4-28	RTP-NA-2520-28	RTP-NA-M6

Designed for Thin-Wall & Flush Threaded Inserts up to 1/4-20in Steel



See below for replacement mandrels

REPLACEMENT MANDRELS

PART NUMBER	SIZE
RTP-M-0440-1.5	4-40 x 1.5"
RTP-M-0632-1.5	6-32 x 1.5"
RTP-M-0832-1.5	8-32 x 1.5"
RTP-M-1024-1.75	10-24 x 1.75"
RTP-M-1032-1.75	10-32 x 1.75"
RTP-M-2520-1.75	1/4-20 x 1.75"
RTP-M-2528-1.75	1/4-28 x 1.75"
RTP-M-M03-5-40	M3-.5 x 40mm
RTP-M-M04-7-40	M4-.7 x 40mm
RTP-M-M05-8-45	M5-.8 x 45mm
RTP-M-M06-1-45	M6-1.0 x 45mm



HANSON RIVET®
 & SUPPLY CO.
 13241 Weidner Street
 Pacoima, CA 91331

Phone: 818-485-0500

FAX: 818-485-0540

Outside CA: 1-800-RRRIVET

www.hansonrivet.com



PULL-UP STUD NOSE ASSEMBLIES FOR 800 SERIES TOOLS



**FOR SETTING PULL-UP STUD THREADED INSERTS
 FROM 6-32 TO 3/8-16 & M4 TO M10**



UNIFIED THREAD NOSE ASSEMBLIES	
THREAD SIZE	PART NUMBER
6-32	RTP-NA-PS-0632
8-32	RTP-NA-PS-0832
10-24	RTP-NA-PS-1024
10-32	RTP-NA-PS-1032
1/4-20	RTP-NA-PS-2520
5/16-18	RTP-NA-PS-3118
3/8-16	RTP-NA-PS-3716

METRIC THREAD NOSE ASSEMBLIES	
THREAD SIZE	PART NUMBER
M4-.70	RTP-NA-PS-M4
M5-.80	RTP-NA-PS-M5
M6-1.0	RTP-NA-PS-M6
M8-1.25	RTP-NA-PS-M8
M10-1.5	RTP-NA-PS-M10

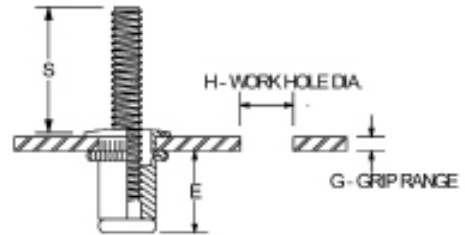
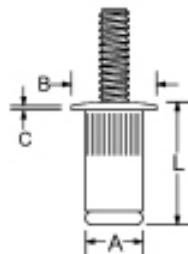

PULL-UP STUDS

STUD THREAD SIZE	STEEL - YELLOW ZINC - PART NUMBER			GRIP RANGE	BODY DIAMETER (MAX.)	FLANGE DIAMETER	FLANGE HEIGHT	LENGTH (MAX.)	REFERENCE	WORK HOLE DIAMETER
	THE LAST DIGITS OF PART NUMBER ARE THE STUD LENGTH "S" (AT MAX GRIP)									
	"G"	"A"	"B"							
6-32	PS6-32-80-500	PS6-32-80-625	PS6-32-80-750	.020-.080	.265	.390	.030	.490	.375	.266
	PS6-32-130-450	PS6-32-130-575	PS6-32-130-700	.080-.130	.265	.390	.030	.540	.375	.266
	PS8-32-80-500	PS8-32-80-625	PS8-32-80-750	.020-.080	.265	.390	.030	.490	.375	.266
	PS8-32-130-450	PS8-32-130-575	PS8-32-130-700	.080-.130	.265	.390	.030	.540	.375	.266
10-24	PS10-24-130-500	PS10-24-130-625	PS10-24-130-750	.020-.130	.296	.415	.030	.545	.385	.297
	PS10-24-225-405	PS10-24-225-530	PS10-24-225-655	.130-.225	.296	.415	.030	.655	.385	.297
	PS10-32-130-500	PS10-32-130-625	PS10-32-130-750	.020-.130	.296	.415	.030	.545	.385	.297
	PS10-32-225-405	PS10-32-225-530	PS10-32-225-655	.130-.225	.296	.415	.030	.655	.385	.297
10-32	PS250-20-165-625	PS250-20-165-8125	PS250-20-165-1000	.027-.165	.390	.500	.030	.670	.470	.391
	PS250-20-260-530	PS250-20-260-7175	PS250-20-260-905	.165-.260	.390	.500	.030	.770	.470	.391
	PS312-18-150-625	PS312-18-150-875	PS312-18-150-1125	.027-.150	.530	.685	.035	.805	.585	.531
	PS312-18-312-463	PS312-18-312-713	PS312-18-312-963	.150-.312	.530	.685	.035	.920	.540	.531
3/8-16	PS375-16-150-750	PS375-16-150-1000	PS375-16-150-1250	.027-.150	.530	.685	.035	.805	.585	.531
	PS375-16-312-588	PS375-16-312-838	PS375-16-312-1088	.150-.312	.530	.685	.035	.920	.540	.531
M4-.70	PS4-70-2.0-12.0	PS4-70-2.0-15.0	PS4-70-2.0-20.0	0.50-2.00	6.73	9.91	0.76	12.45	9.53	6.75
	PS4-70-3.3-10.7	PS4-70-3.3-13.7	PS4-70-3.3-18.7	2.00-3.30	6.73	9.91	0.76	13.72	9.53	6.75
	PS5-80-3.3-12.0	PS5-80-3.3-15.0	PS5-80-3.3-20.0	0.50-3.30	7.52	10.54	0.76	13.85	9.78	7.60
	PS5-80-5.7-9.6	PS5-80-5.7-12.6	PS5-80-5.7-17.6	3.30-5.70	7.52	10.54	0.76	16.64	9.78	7.60
M5-.80	PS6-10-4.2-15.0	PS6-10-4.2-20.0	PS6-10-4.2-25.0	0.70-4.20	9.91	12.70	0.76	17.02	11.94	10.00
	PS6-10-6.6-12.6	PS6-10-6.6-17.6	PS6-10-6.6-22.6	4.20-6.60	9.91	12.70	0.76	19.56	11.94	10.00
M6-1.0	PS8-125-3.8-16.0	PS8-125-3.8-22.0	PS8-125-3.8-28.0	0.70-3.80	13.46	17.40	0.89	20.45	14.86	13.50
	PS8-125-7.9-11.9	PS8-125-7.9-17.9	PS8-125-7.9-23.9	3.80-7.90	13.46	17.40	0.89	23.37	13.72	13.50
M8-1.25	PS10-150-3.8-20.0	PS10-150-3.8-25.0	PS10-150-3.8-30.0	0.70-3.80	13.46	17.40	0.89	20.45	14.86	13.50
	PS10-150-7.9-5.9	PS10-150-7.9-20.9	PS10-150-7.9-25.9	3.80-7.90	13.46	17.40	0.89	23.37	13.72	13.50